

# Poly CCX 400 Business Media Phone

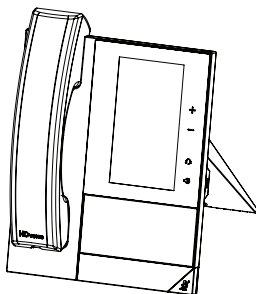

## Package Contents

CCX 400

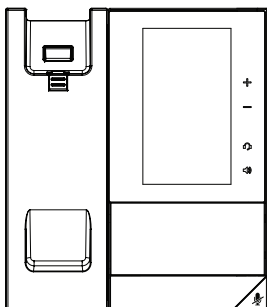

Handset

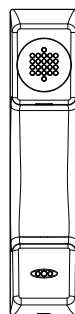

Stand

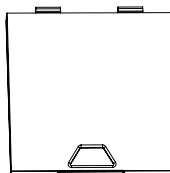

Setup Sheet



Handset Cord



Network Cable

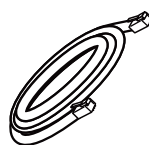

## Optional Accessories



AC Power Adapter  
(varies by region)

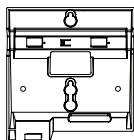

Wallmount

# Features

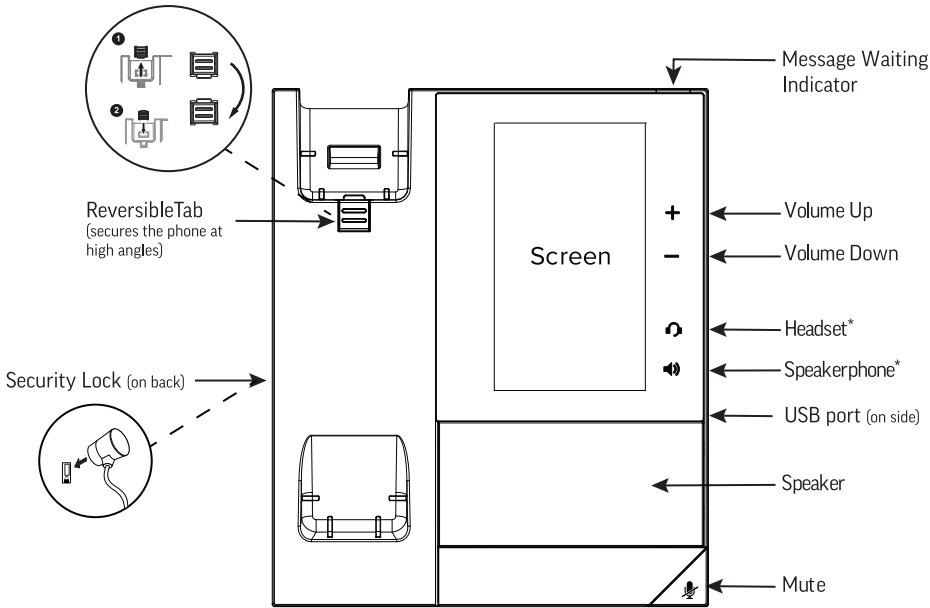

## Connect Desktop Stand

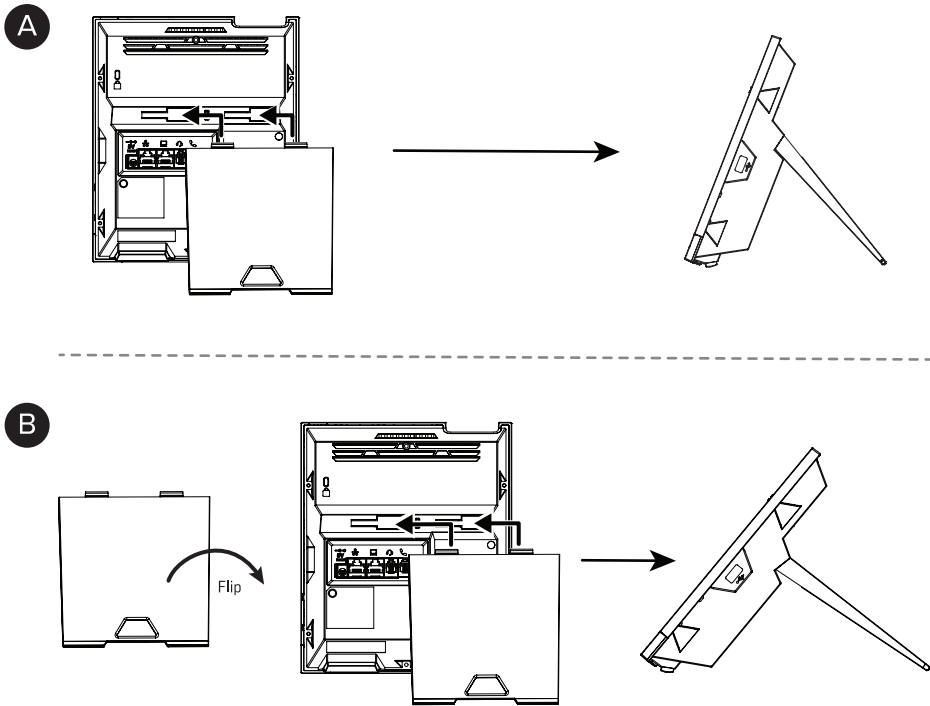

# Connect Cables

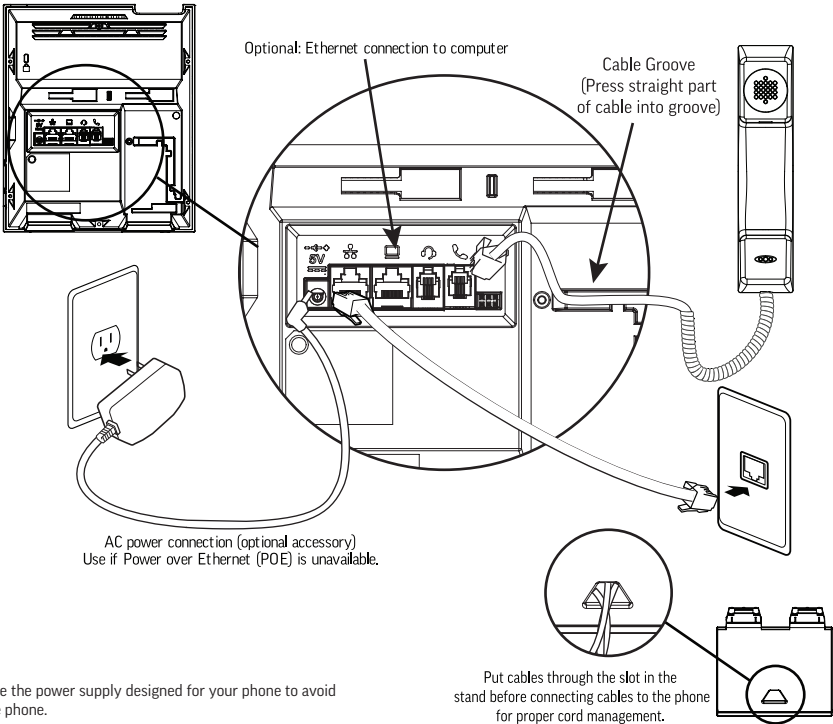

# Connect Optional Headset

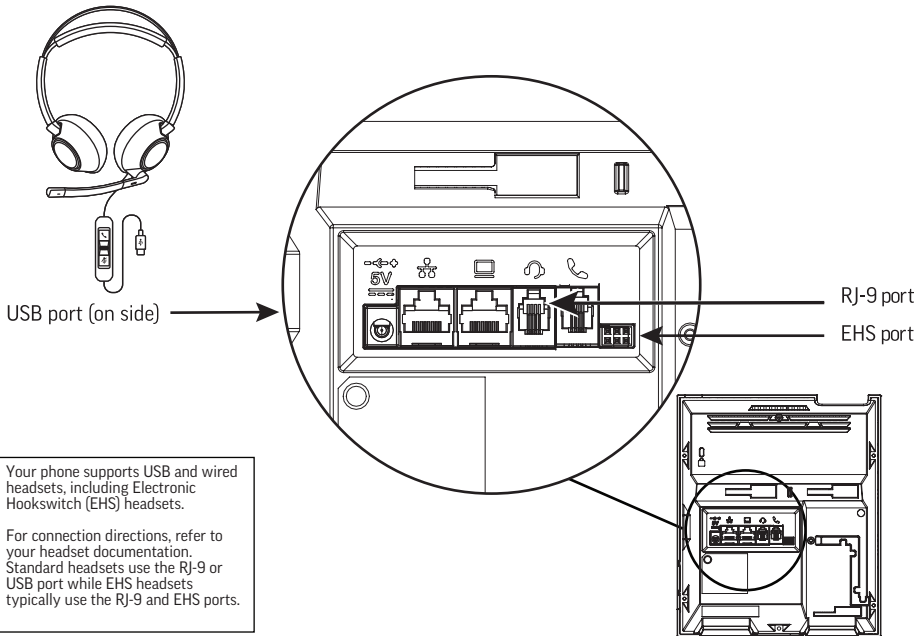



BY USING THIS PRODUCT, YOU ARE AGREEING TO THE TERMS OF THE END USER LICENSE AGREEMENT (EULA) AT:  
<http://documents.polycom.com/indexes/licenses>. IF YOU DO NOT AGREE TO THE TERMS OF THE EULA, DO NOT USE THE PRODUCT, AND YOU MAY RETURN IT IN THE ORIGINAL PACKAGING TO THE SELLER FROM WHOM YOU PURCHASED THE PRODUCT.

Refer to the Limited Warranty section of the Product Warranty Guide found under Service Policies at  
<http://support.polycom.com/>

#### UKCA

UK representative: Plantronics Ltd, Building 4, Foundation Park, Cannon Lane, Part 1st Floor, Maidenhead, SL6 3UD

#### ENERGY STAR®:



Backlight intensity and timeout can be adjusted in basic user settings menu. By default, after the phone is idle for 40 seconds, the backlight dims. The backlight automatically turns on with any phone activity.



[support.polycom.com/voice](http://support.polycom.com/voice)

© 2021 Plantronics, Inc. All rights reserved. Poly, the propeller design, and the Poly logo are trademarks of Plantronics, Inc. All other trademarks are the property of their respective owners.

#### Contact Information:

Contact your Authorized Reseller for Assistance.  
[www.poly.com](http://www.poly.com)

Plantronics, Inc. 345 Encinal Street Santa Cruz, California 95060

1725-49705-001C

